

# Fitting Series

φ4, φ6, φ8, φ10, φ12

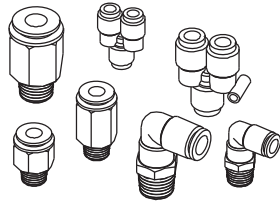

## Specification

Max pressure	MPa (bar)	1.2 (12.0)
Pressure range		0.99 (9.9)
Temperature range	°C	5~60
Fluid		Air, Water
Material		Nylon, Polyuretans
Port size		M5, 1/8, 1/4, 3/8, 1/2
Tube OD	mm	φ4, φ6, φ8, φ10, φ12

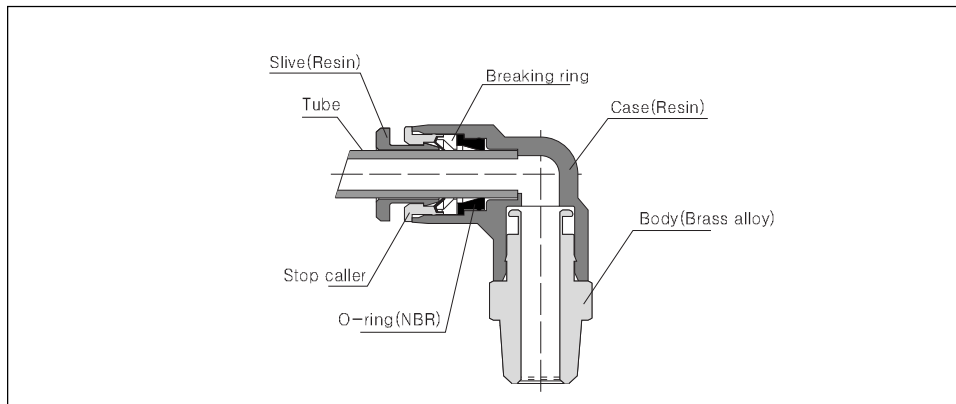

# Fitting Series

## Kind of Connector

kind of connector	Model	port size	Apply tube ( $\phi$ )				
			4	6	8	10	12
Male	FSC	M5	○	○			
		1/8	○	○	○	○	
		1/4	○	○	○	○	○
		3/8			○	○	○
		1/2			○	○	○
Male	FACL	M5	○	○			
		1/8	○	○	○	○	
		1/4	○	○	○	○	○
		3/8		○	○	○	○
		1/2			○	○	○
Male elbow	FSE	M5	○	○			
		1/8	○	○	○	○	
		1/4	○	○	○	○	○
		3/8		○	○	○	○
		1/2			○	○	○
Long elbow	FLE	M5	○	○			
		1/8	○	○	○	○	
		1/4	○	○	○	○	○
		3/8		○	○	○	○
Female	FSF	1/8	○	○	○	○	
		1/4	○	○	○	○	○
		3/8			○	○	○
Female	FSFP	1/8	○	○	○	○	
		1/4	○	○	○	○	○
		3/8			○	○	○
Male branch tee swivel	FST	M5	○	○	○		
		1/8	○	○	○	○	
		1/4	○	○	○	○	○
		3/8		○	○	○	○
		1/2			○	○	○
Male branch tee swivel	FSTL	M5	○	○			
		1/8	○	○	○	○	
		1/4	○	○	○	○	○
		3/8		○	○	○	○
		1/2			○	○	○
Bulkhead equal union	FSB	-	○	○	○	○	○
Union Y male	FSY	M5	○	○			
		1/8	○	○	○	○	
		1/4	○	○	○	○	○
		3/8		○	○	○	○
		1/2			○	○	○
Male elbow	FSES	M5	○	○			
		1/8	○	○			
		1/4		○	○	○	
		3/8			○	○	○
		1/2				○	○
Union cross	FUC	-	○	○	○	○	○
Plyg-in Y elbow	FEY	-	○	○	○	○	○
Plyg-in elbow	FEP		○	○	○	○	○
Plyg-in Y	FEYR	06	○				
		08		○			
		10			○		
		12				○	
Equal union reducer	FUER	06	○				
		08		○			
		10			○		
		12				○	
Union Y reducer	FUZR	06	○				
		08		○			
		10			○		
		12				○	
Union manifold	FUM	$\phi 4$		○	○		
		$\phi 6$			○	○	
		$\phi 8$				○	
Union manifold	FUMC	1/8( $\phi 4$ )		○			
		1/4( $\phi 4$ )			○		
		1/4( $\phi 6$ )				○	
		3/8( $\phi 8$ )					○
Union manifold	FUML	$\phi 4$		○	○		
		$\phi 6$			○		
		$\phi 8$				○	
Union	FUT	-	○	○	○	○	○
Union Y	FUY	-	○	○	○	○	○
Equal union	FUE	-	○	○	○	○	○
Union elbow	FUL	-	○	○	○	○	○

## Fitting Series

### Male connector / FSC

(unit : mm)

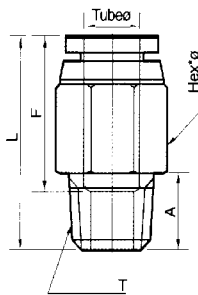

order code	Apply tybe dia. (φ)	T	L	A	Tube insert depth (F)	Hex
FSC04-M5	4	M5×0.8P	21.9	4.6	15.9	10×11.5
FSC04-1/8	4	R 1/8	21.6	8	15.9	10×11.5
FSC04-1/4	4	R 1/4	20.6	10	15.9	14×16.1
FSC06-M5	6	M5×0.8P	23.6	4.6	16.5	10×11.5
FSC06-1/8	6	R1/8	22.2	8	16.5	12×13.8
FSC06-1/4	6	R1/4	21	10	16.5	14×16.1
FSC06-3/8	6	R3/8	22	11	16.5	17×18.5
FSC08-1/8	8	R1/8	27.5	8	17.7	12×13.0
FSC08-1/4	8	R1/4	25.5	10	17.7	14×15.4
FSC08-3/8	8	R3/8	23	11	17.7	17×18.5
FSC08-1/2	8	R1/2	29.7	14	17.7	22×24.5
FSC10-1/8	10	R1/8	28.7	8	18.6	12×13.0
FSC10-1/4	10	R1/4	30.7	10	18.6	14×15.4
FSC10-3/8	10	R3/8	24.7	11	18.6	17×18.5
FSC10-1/2	10	R1/2	29.7	14	18.6	22×24.5
FSC12-1/4	12	R1/4	32.8	10	20.9	14×15.4
FSC12-3/8	12	R3/8	29.8	11	20.9	17×18.5
FSC12-1/2	12	R1/2	29.8	14	20.9	22×24.5

### Male connector / FSCL

(unit : mm)

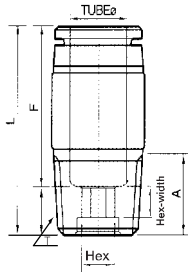

order code	Apply tybe dia. (φ)	T	L	A	Tube insert depth (F)	Hex
FSCL04-M5	4	M5×0.8P	21.8	4.6	15.9	02×2.31
FSCL04-1/8	4	R1/8	20.4	8	15.9	03×3.46
FSCL04-1/4	4	R1/4	20.4	10	15.9	03×3.46
FSCL06-M5	6	M5×0.8P	22.6	4.6	16.5	02×2.31
FSCL06-1/8	6	R1/8	21.8	8	16.5	04×4.62
FSCL06-1/4	6	R1/4	22.5	10	16.5	04×4.62
FSCL06-3/8	6	R3/8	22.5	11	16.5	04×4.62
FSCL08-1/8	8	R1/8	27	8	17.7	06×6.93
FSCL08-1/4	8	R1/4	25	10	17.7	06×6.93
FSCL08-3/8	8	R3/8	25	11	17.7	06×6.93
FSCL08-1/2	8	R1/2	25	14	17.7	05×5.77
FSCL10-1/8	10	R1/8	27	8	18.6	06×6.93
FSCL10-1/4	10	R1/4	26.6	10	18.6	06×6.93
FSCL10-3/8	10	R3/8	26.6	11	18.6	06×6.93
FSCL10-1/2	10	R1/2	26.6	14	18.6	06×6.93
FSCL12-1/4	12	R1/4	32.4	10	20.9	06×6.93
FSCL12-3/8	12	R3/8	32.4	11	20.9	08×9.24
FSCL12-1/2	12	R1/2	32.4	14	20.9	08×9.24

### Female connector / FSF

(unit : mm)

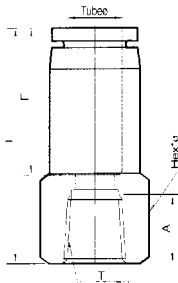

order code	Apply tybe dia. (φ)	T	L	A	Tube insert depth (F)	Hex
FSF04-1/8	4	PT1/8	26.7	9	15.9	12×13.0
FSF04-1/4	4	PT1/4	28.7	11	15.9	14×15.4
FSF06-1/8	6	PT1/8	27.3	9	16.5	12×13.0
FSF06-1/4	6	PT1/4	29.3	11	16.5	14×15.4
FSF06-3/8	6	PT3/8	30.2	12	16.5	17×18.5
FSF08-1/8	8	PT1/8	28.5	9	17.7	12×13.0
FSF08-1/4	8	PT1/4	30.5	11	17.7	14×15.4
FSF08-3/8	8	PT3/8	31.5	12	17.7	17×18.5
FSF10-1/8	10	PT1/8	31.4	9	18.6	12×13.0
FSF10-1/4	10	PT1/4	31.5	11	18.6	14×15.4
FSF10-3/8	10	PT3/8	32.4	12	18.6	17×18.5
FSF12-1/4	12	PT1/4	34.7	11	20.9	14×15.4
FSF12-3/8	12	PT3/8	34.7	12	20.9	17×18.5
FSF12-1/2	12	PT1/2	36.7	14	20.9	22×24.5

## Fitting Series

### Female connector / FSFP

(unit : mm)

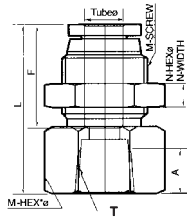

order code	Apply tybe dia. (φ)	T	L	N	M	A	HexN	Tube insert depth (F)	Hex
FSFP04-1/8	4	PT1/8	26.7	5	M12×1.0P	9	14×16.1	16.8	14×16.1
FSFP06-1/8	6	PT1/8	28.3	5	M14×1.0P	9	17×19.6	17.6	17×19.6
FSFP06-1/4	6	PT1/4	30.3	5	M14×1.0P	11	17×19.6	17.6	17×19.6
FSFP08-1/8	8	PT1/8	29.5	5	M16×1.0P	9	19×21.9	18.7	19×21.9
FSFP08-1/4	8	PT1/4	31.5	5	M16×1.0P	11	19×21.9	18.7	19×21.9
FSFP08-3/8	8	PT3/8	32.5	5	M16×1.0P	12	19×21.9	18.7	22×25.4
FSFP10-1/4	10	PT1/4	32.4	5	M20×1.0P	11	24×27.7	19.6	24×27.7
FSFP10-3/8	10	PT3/8	33.4	5	M20×1.0P	12	24×27.7	19.6	24×27.7
FSFP12-1/4	12	PT1/4	37.9	5	M22×1.0P	11	26×30.0	21.9	24×27.7
FSFP12-3/8	12	PT3/8	37.9	5	M22×1.0P	12	26×30.0	21.9	24×27.7
FSFP12-1/2	12	PT1/2	39.9	5	M22×1.0P	14	26×30.0	21.9	24×27.7

### Bulkhead equal union / FSB

(unit : mm)

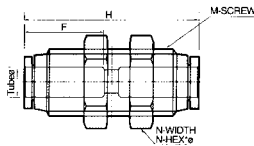

order code	Apply tybe dia. (φ)	H	Tube insert depth (F)	M	N- depth (N-Hex)
FSB04	4	29.8	16.3	M12×10P	5(14×16.1)
FSB06	6	33	17.6	M14×10P	5(17×19.6)
FSB08	8	35.4	18.7	M16×10P	5(19×21.9)
FSB10	10	37.8	19.6	M20×10P	5(24×27.7)
FSB12	12	47.4	21.9	M22×10P	5(26×30.0)

### Male elbow swivel / FSE

(unit : mm)

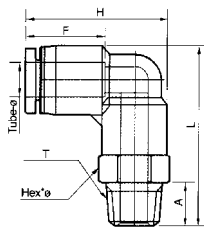

order code	Apply tybe dia. (φ)	T	L	H	Tube insert depth (F)	Hex
FSE04-M5	4	M5×0.8P	27.25	23.8	4.6	10×11.0
FSE04-1/8	4	PT1/8	29.75	23.8	8	10×11.0
FSE04-1/4	4	PT1/4	31.75	23.8	10	14×15.4
FSE06-M5	6	M5×0.8P	30.25	26.5	4.6	10×11.0
FSE06-1/8	6	PT1/8	32.75	26.5	8	12×13.0
FSE06-1/4	6	PT1/4	35.75	26.5	10	14×15.4
FSE06-3/8	6	PT3/8	36.75	26.5	11	17×18.5
FSE08-1/8	8	PT1/8	35.15	29.7	8	12×13.0
FSE08-1/4	8	PT1/4	38.15	29.7	10	14×15.4
FSE08-3/8	8	PT3/8	39.15	29.7	11	17×18.5
FSE08-1/2	8	PT1/2	42.15	29.7	14	22×24.5
FSE10-1/8	10	PT1/8	37.25	32.1	8	12×13.0
FSE10-1/4	10	PT1/4	40.25	32.1	10	14×15.4
FSE10-3/8	10	PT3/8	41.25	32.1	11	17×18.5
FSE10-1/2	10	PT1/2	44.25	32.1	14	22×24.5
FSE12-1/4	12	PT1/4	44.65	36.9	10	14×15.4
FSE12-3/8	12	PT3/8	45.65	36.9	11	17×18.5
FSE12-1/2	12	PT1/2	48.65	36.9	14	22×24.5

## Fitting Series

### Long elbow / FLE

(unit : mm)

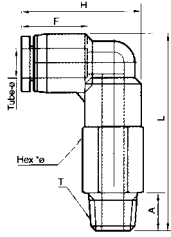

order code	Apply tybe dia. ( $\phi$ )	T	L	H	A	Tube insert depth (F)	Hex
FLE04-M5	4	M5×0.8P	38.75	23.8	4.6	16.8	10×11.0
FLE04-1/8	4	PT1/8	40.75	23.8	8	16.8	10×11.0
FLE04-1/4	4	PT1/4	42.75	23.8	10	16.8	14×15.4
FLE06-M5	6	M5×0.8P	44.25	26.5	4.6	17.6	10×11.0
FLE06-1/8	6	PT1/8	46.25	26.5	8	17.6	12×13.0
FLE06-1/4	6	PT1/4	48.25	26.5	10	17.6	14×15.4
FLE06-3/8	6	PT3/8	49.25	26.5	11	17.6	17×18.5
FLE08-1/8	8	PT1/8	51.15	29.7	8	18.7	12×13.0
FLE08-1/4	8	PT1/4	53.15	29.7	10	18.7	14×15.4
FLE08-3/8	8	PT3/8	54.15	29.7	11	18.7	17×18.5
FLE08-1/2	8	PT1/2	57.15	29.7	14	18.7	22×24.5
FLE10-1/8	10	PT1/8	48.45	32.1	8	19.6	12×13.0
FLE10-1/4	10	PT1/4	50.45	32.1	10	19.6	14×15.4
FLE10-3/8	10	PT3/8	51.45	32.1	11	19.6	17×18.5
FLE10-1/2	10	PT1/2	54.45	32.1	14	19.6	22×24.5
FLE12-1/4	12	PT1/4	66.15	36.9	10	21.9	14×15.4
FLE12-3/8	12	PT3/8	67.15	36.9	11	21.9	17×18.5
FLE12-1/2	12	PT1/2	70.15	36.9	14	21.9	22×24.5

### Plug-in elbow / FEP

(unit : mm)

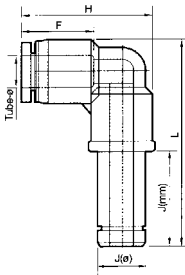

order code	Apply tybe dia. ( $\phi$ )	J(mm)	J $\phi$	L	H	Tube insert depth (F)
FEP04	4	20.5	4	39.2	23.8	16.8
FEP06	6	23	6	44.7	26.5	17.6
FEP08	8	26.5	8	50.6	28.4	18.7
FEP10	10	29	10	55.2	32.1	19.6
FEP12	12	33.3	12	63.9	36.9	21.9

### Male branch tee swivel / FST

(unit : mm)

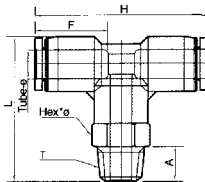

order code	Apply tybe dia. ( $\phi$ )	T	L	H	A	Tube insert depth (F)	Hex
FST04-M5	4	M5×0.8P	27.25	37.6	4.6	16.8	10×11.5
FST04-1/8	4	PT1/8	29.75	37.6	8	16.8	10×11.5
FST04-1/4	4	PT1/4	31.75	37.6	10	16.8	14×16.1
FST06-M5	6	M5×0.8P	30.25	41	4.6	17.6	10×11.5
FST06-1/8	6	PT1/8	32.75	41	8	17.6	12×13.8
FST06-1/4	6	PT1/4	35.75	41	10	17.6	14×16.1
FST06-3/8	6	PT3/8	36.75	41	11	17.6	17×19.6
FST08-1/8	8	PT1/8	35.25	44.4	8	18.7	12×13.8
FST08-1/4	8	PT1/4	38.25	44.4	10	18.7	14×16.1
FST08-3/8	8	PT3/8	39.25	44.4	11	18.7	17×19.6
FST08-1/2	8	PT1/2	42.25	44.4	14	18.7	22×25.4
FST10-1/8	10	PT1/8	37.25	47.2	8	19.6	12×13.8
FST10-1/4	10	PT1/4	40.25	47.2	10	19.6	14×16.1
FST10-3/8	10	PT3/8	41.25	47.2	11	19.6	17×19.6
FST10-1/2	10	PT1/2	44.25	47.2	14	19.6	22×25.4
FST12-1/4	12	PT1/4	44.65	54.8	10	21.9	14×16.1
FST12-3/8	12	PT3/8	45.65	54.8	11	21.9	17×19.6
FST12-1/2	12	PT1/2	48.65	54.8	14	21.9	22×25.4

## Fitting Series

### Male branch tee swivel / FSTL

(unit : mm)

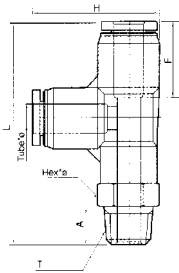

order code	Apply tybe dia. ( $\phi$ )	T	L	H	A	Tube insert depth (F)	Hex
FSTL04-M5	4	M5×0.3P	42.3	25.1	4.6	16.8	10×11.5
FSTL04-1/8	4	PT1/8	45.3	25.1	8	16.8	10×11.5
FSTL04-1/4	4	PT1/4	48.3	25.1	10	16.8	14×16.1
FSTL06-M5	6	M5×0.8P	46.1	28.1	4.6	17.6	10×11.5
FSTL06-1/8	6	PT1/8	48.6	28.1	8	17.6	12×13.8
FSTL06-1/4	6	PT1/4	51.2	28.1	10	17.6	14×16.1
FSTL06-3/8	6	PT3/8	52.2	28.1	11	17.6	17×19.6
FSTL08-1/8	8	PT1/8	52.2	30.9	8	18.7	12×13.8
FSTL08-1/4	8	PT1/4	55.2	30.9	10	18.7	14×16.1
FSTL08-3/8	8	PT3/8	56.2	30.9	11	18.7	17×19.6
FSTL08-1/2	8	PT1/2	59.2	30.9	14	18.7	22×25.4
FSTL10-1/8	10	PT1/8	55.6	34.6	8	19.6	12×13.8
FSTL10-1/4	10	PT1/4	58.6	34.6	10	19.6	14×16.1
FSTL10-3/8	10	PT3/8	59.6	34.6	11	19.6	17×19.6
FSTL10-1/2	10	PT1/2	62.6	34.6	14	19.6	22×25.4
FSTL12-1/4	12	PT1/4	64.8	40.3	10	21.9	14×16.1
FSTL12-3/8	12	PT3/8	65.8	40.3	11	21.9	17×19.6
FSTL12-1/2	12	PT1/2	68.8	40.3	14	21.9	22×25.4

### Union Y male connector / FSTL

(unit : mm)

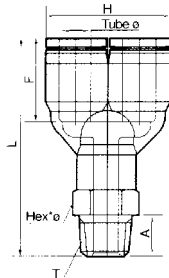

order code	Apply tybe dia. ( $\phi$ )	T	L	H	A	Tube insert depth (F)	Hex
FSY04-M5	4	M5×0.8P	34.8	21	4.6	16.8	10×11.5
FSY04-1/8	4	PT1/8	41.3	21	8	16.8	10×11.5
FSY04-1/4	4	PT1/4	42.3	21	10	16.8	14×16.1
FSY06-M5	6	M5×0.8P	41.6	25	4.6	17.6	10×11.5
FSY06-1/8	6	PT1/8	44.1	25	8	17.6	12×13.8
FSY06-1/4	6	PT1/4	47.1	25	10	17.6	14×16.1
FSY06-3/8	6	PT3/8	48.1	25	11	17.6	17×19.6
FSY08-1/8	8	PT1/8	45.5	29	8	18.7	12×13.8
FSY08-1/4	8	PT1/4	48.5	29	10	18.7	14×16.1
FSY08-3/8	8	PT3/8	48.5	29	11	18.7	17×19.6
FSY08-1/2	8	PT1/2	52.5	29	14	18.7	22×25.4
FSY10-1/8	10	PT1/8	49.2	35	8	19.6	12×13.8
FSY10-1/4	10	PT1/4	52.2	35	10	19.6	14×16.1
FSY10-3/8	10	PT3/8	53.2	35	11	19.6	17×19.6
FSY10-1/2	10	PT1/2	56.2	35	14	19.6	22×25.4
FSY12-1/4	12	PT1/4	54.5	41	10	21.9	14×16.1
FSY12-3/8	12	PT3/8	55.4	41	11	21.9	17×19.6
FSY12-1/2	12	PT1/2	58.4	41	14	21.9	22×25.4

### Plug-in Y connector / FEY

(unit : mm)

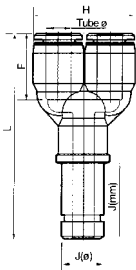

order code	Apply tybe dia. ( $\phi$ )	J	J( $\phi$ )	L	H	Tube insert depth (F)
FEY04	4	20.5	4	56.7	21	16.8
FEY06	6	23	6	61.1	25	17.6
FEY08	8	26.5	8	67.4	29	18.7
FEY10	10	29	10	74	35	19.6
FEY12	12	33.3	12	83.6	41	21.9

## Fitting Series

### Plug-in Y connector / FEYR

(unit : mm)

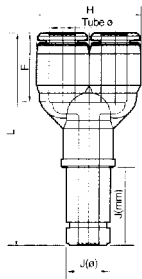

order code	Apply tybe dia. (φ)	J	J (φ)	L	H	Tube insert depth (F)
FEYR0604	4	23	6	56.2	21	17.6
FEYR0806	6	26.5	8	61	25	18.7
FEYT1008	8	29	10	69.1	29	19.6
FEYR1210	10	33.3	12	76.7	35	21.9

### Equal union / FUE

(unit : mm)

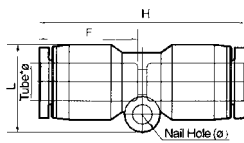

order code	Apply tybe dia. (φ)	H	L	Nail hole (φ)	Tube insert depth (F)
FUE04	4	34.6	12.75	3.3	16.8
FUE06	6	36.8	14.75	3.3	17.6
FUE08	8	39.4	19.85	4.3	18.7
FUE10	10	43.2	20	4.3	19.6
FUE12	12	47.8	23.3	4.3	21.9

### Union elbow / FUL

(unit : mm)

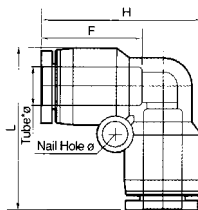

order code	Apply tybe dia. (φ)	H	L	Nail hole (φ)	Tube insert depth (F)
FUL04	4	36.6	24.2	3.3	16.8
FUL06	6	41.8	27.5	3.3	17.6
FUL08	8	44.9	30.65	4.3	18.7
FUL10	10	48.2	34.05	4.3	19.6
FUL12	12	56.8	39.85	4.3	21.9

### Union Tee / FUT

(unit : mm)

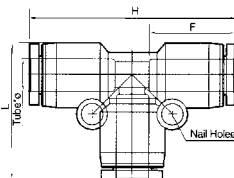

order code	Apply tybe dia. (φ)	H	L	Nail hole (φ)	Tube insert depth (F)
FUT04	4	36.6	24.2	3.3	16.8
FUT06	6	41.8	27.5	3.3	17.6
FUT08	8	44.9	30.65	4.3	18.7
FUT10	10	48.2	34.05	4.3	19.6
FUT12	12	56.8	39.85	4.3	21.9

## Fitting Series

### Equal union reducer / FUER

(unit : mm)

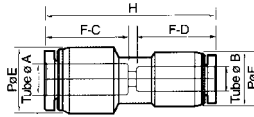

order code	Apply tybe dia. (φ)		H	F-C	F-D	PφE	PφF
	A	B					
FUER06-04	6	4	36.6	17.6	16.8	12.5	10.5
FUER08-06	8	6	37.6	18.7	17.6	14.5	12.5
FUER10-08	10	8	41	19.6	18.7	17.5	14.5
FUER12-10	12	10	44	21.9	19.6	20.5	17.5

### Union Y connector / FUY

(unit : mm)

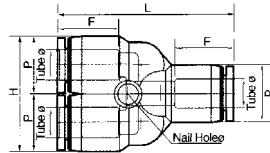

order code	Apply tybe dia. (φ)	H	L	F	φP	Nail hole (φ)
FUY04	4	21	37.1	16.8	10.5	3.3
FUY06	6	25	40.2	17.6	12.5	3.3
FUY08	8	29	43.4	18.7	14.5	4.3
FUY10	10	35	47.7	19.6	17.5	4.3
FUY12	12	41	53.3	21.9	20.5	4.3

### Union Y connector reducer / FUYR

(unit : mm)

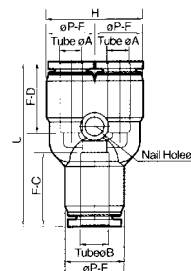

order code	Apply tybe dia. (φ)		L	H	F-C	F-D	PφE	PφF	Nail hole (φ)
	A	B							
FUYR06-04	6	4	37.9	21	17.6	16.8	12.5	10.5	3.3
FUYR08-06	8	6	41.3	25	18.7	17.6	14.5	12.5	4.3
FUYR10-08	10	8	43.3	29	19.6	18.7	17.5	14.5	4.3
FUYR12-10	12	10	46.5	35	21.9	19.6	20.5	17.5	4.3

### Union cross / FUC

(unit : m m)

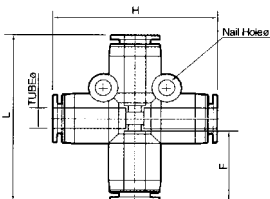

order code	Apply tybe dia. (φ)	Nail hole (φ)	H	L	T
FUC04	4	3.3	36.6	37.9	16.8
FUC06	6	3.3	41.8	42.5	17.6
FUC09	8	4.3	44.9	46.8	18.7
FUC10	10	4.3	48.2	50.5	19.6
FUC12	12	4.3	54.8	57.2	21.9



## Fitting Series

### Union manifold connector / FUM

(unit : mm)

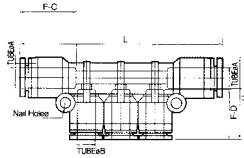

order code	Apply tybe dia. (φ)		Nail hole (φ)	H	L	Tube insert depth (F)	F-D
	A	B					
FUM06-04	6	4	3.3	24.2	63.7	17.6	16.8
FUM08-04	8	4	4.3	28.5	65.7	18.7	16.8
FUM08-06	8	6	4.3	34	71.7	18.7	17.6
FUM10-06	10	6	4.3	32	78.1	19.6	17.6
FUM10-08	10	8	4.3	34.5	83.4	19.6	18.7

### Union manifold connector / FUMC

(unit : mm)

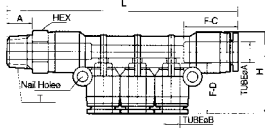

order code	Apply tybe dia. (φ)		Nail hole (φ)	H	L	Tube insert depth (F)	F-D	A	T	Hex
	A	B								
FUMC0604-1/8	6	4	3.3	24.2	72.3	17.6	16.8	8	1/8	12×13.8
FUMC0804-1/4	8	4	4.3	28.5	77.2	18.7	16.8	10	1/4	17×19.6
FUMC0806-1/4	8	6	4.3	34	84.4	18.7	17.6	10	1/4	17×19.6
FUMC1008-3/8	10	8	4.3	34.5	91	19.6	18.7	11	3/8	22×25.4

### Union manifold connector / FUML

(unit : mm)

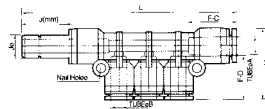

order code	Apply tybe dia. (φ)		Nail hole (φ)	H	L	Tube insert depth (F)	F-D	J	J (φ)
	A	B							
FUML0604	6	4	3.3	24.2	84.3	17.6	16.8	25	6
FUML0804	8	4	4.3	28.5	89.5	18.7	16.8	28.5	8
FUML0806	8	6	4.3	34	95.5	18.7	17.6	28.5	8
FUML1008	10	8	4.3	34.5	109.7	19.6	18.7	31	10

### Male elbow / FSES

(unit : mm)

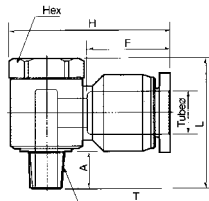

order code	Apply tybe dia. (φ)	T	L	H	A	Hex
FSES04-M5	4	M5×0.8P	22.1	26.6	4.6	8×9.24
FSES04-1/8	4	PT1/8	32.4	31.5	8	14×16.8
FSES06-M5	6	M5×0.8P	22.1	27.2	4.6	8×9.24
FSES06-1/8	6	PT1/8	32.4	32.4	8	14×16.8
FSES06-1/4	6	PT1/4	35.3	35.6	10	17×19.6
FSES08-1/8	8	PT1/8	32.4	39.2	8	14×16.8
FSES08-1/4	8	PT1/4	35.3	37.7	10	17×19.6
FSES08-3/8	8	PT3/8	39.7	42.7	11	21×24.2
FSES10-1/4	10	PT1/4	35.3	42.5	10	17×19.6
FSES10-3/8	10	PT3/8	39.7	43.6	11	21×24.2
FSES10-1/2	10	PT1/2	47.8	45.6	14	24×27.7
FSES12-3/8	12	PT3/8	39.7	45.9	11	21×24.2
FSES12-1/2	12	PT1/2	47.8	48.3	14	24×27.7